

1. DIMENSIONS TO FACE OF PARTITIONS ARE TO FACE OF STUD. FINISHES DEPICTED IN FINISH PLANS AND ELEVATIONS ARE NOT SHOWN ON PARTIAL FLOOR PLANS. REFER TO ENLARGED PLANS, ELEVATIONS, AND DETAILS.
2. LOCATE DOOR OPENING TO MATCH PERPENDICULAR WALL.
3. FIRE AND SOUND RATED WALLS/PARTITIONS TO BE CONSTRUCTED TIGHT TO STRUCTURE, PILING, DUCTWORK AND OTHER PENETRATIONS. ALL GAPS FULLY SEALED. ALL PARTITIONS TO BE BRICK OR CONCRETE.
4. WHERE PARTITIONS OF DIFFERENT FIRE RATINGS INTERSECT, THE HIGHEST RATED PARTITION SHALL CONTINUE THROUGH. MAINTAIN PARTITION FIRE RATING BEHIND RECESSED FIRE EXTINGUISHER CABINETS.
5. INSTALL LOCKING IN MECHANISMS FOR CASEWORK, WALL MOUNTED EQUIPMENT, TRIM AND RELATED CONSTRUCTION.
6. AT ANY LOCATION WHERE AN INTERIOR WALL TERMINATES AT AN EXTERIOR STOREFRONT, INSTALL MULLION WALL AT INTERSECTION OF WALL AND STOREFRONT.
7. ALL INTERIOR PARTITION LIFE SAFETY: FIRE RATED PARTITIONS SHALL BE CONSTRUCTED TO MATCH LIFE SAFETY PARTITION.
8. SEE SHEET A-001 FOR CONSTRUCTION SUBSYSTEMS AND PARTITION SCHEDULE.
9. SEE SHEET A-710 THROUGH A-733 FOR INTERIOR ELEVATIONS.
10. SEE SHEETS A-804 THROUGH A-804 FOR FINISH FLOORING, TRANSITIONS, PATTERNS AND WALL PROTECTION.
11. SEE SHEETS A-801 & A-802 FOR ENLARGED PLANS INDICATING ADDITIONAL DIMENSION AND PARTITION TYPES, ACCESSORIES AND MOUNTING HEIGHTS.
12. SEE STRUCTURAL DRAWING FOR CONSTRUCTION OF WALLS AND WALLS.
13. WHERE STRUCTURAL STEEL MEMBERS ARE EXPOSED AND NOT CONCEALED W/OTHER CONSTRUCTION, PAINT FINISH TO MATCH STOREFRONT/ CURTAIN WALL FRAME SYSTEMS, TYPE.
14. GYPSUM WALL BOARD ON EXTERIOR WALLS IS PART OF CORE & SHELL PHASE.
15. INSTALL PT WOOD BLOCKING IN WALLS AT ALL SCREEN LOCATIONS. SEE AV DRAWINGS.

1. ALL NON-DESIGNATED PARTITIONS SHALL BE TYPE 3A.
2. THE BACKER BOARD SHALL BE USED IN ALL LOCATIONS TO RECEIVE THE FINISHES.
3. REFER TO FINISH SCHEDULE AND INTERIOR ELEVATIONS FOR LOCATIONS.
4. CONTRACTOR SHALL COORDINATE WITH MECHANICAL DUCTWORK PRIOR TO FABRICATION OF PARTITION WALLS.
5. SHOULD CONDITIONS OCCUR WHERE A WALL IS UNABLE TO GO STRAIGHT UP TO STRUCTURE DUE TO PIPING, DUCTWORK, ETC., THE PARTITION (GYPSUM BOARD AND FINISH) MAY JOG HEREIN TO FOLLOW WALL AND CEILING TO AVOID THE PROBLEM.
6. WHERE WALL INTEGRITY SHALL BE MAINTAINED.
7. RATED WALLS EXTEND TO STRUCTURE AND GYPSUM WALLBOARD AND SOUND ATTENTION BLANKETS EXTEND JUST ABOVE THE FINISH CEILING, CAP OFF PARTITION WITH A RUNNER CHANNEL. WHEN CEILING PLenum IS USED AS A RETURN AIR PLenum.
8. DIMENSIONAL CONFLICTS BETWEEN PARTITION TYPES AND THE ARCHITECTURAL FLOOR PLAN SHALL BE RESOLVED BY THE CONTRACTOR.
9. SEE LIFE SAFETY PLANS FOR THE LOCATIONS OF SMOKE BARRIERS, SMOKE PARTITIONS AND FIRE-RATED PARTITIONS.
10. REFER TO UNDERWRITERS LABORATORIES, INC. FIRE RESISTANCE VOLUMES - CURRENT EDITION FOR SPECIFIC PERFORMANCE REQUIREMENTS OF U.L. LISTED ASSEMBLIES.
11. REFER TO MECHANICAL, ELECTRICAL AND PLUMBING DRAWINGS FOR TYPICAL U.L. LISTED PENETRATIONS THROUGH FIRE-RATED ASSEMBLIES. CONTRACTOR SHALL BE RESPONSIBLE FOR PROVIDING APPROPRIATE PROJECT-SPECIFIC U.L. LISTED ASSEMBLY DETAILATIONS.
12. REFER TO DETAIL MECH. DWGS. FOR TYPICAL WALL FRAMING FOR FIRE DAMPERS IN RATED WALLS. COORDINATE EXACT FRAMING REQUIREMENTS WITH FIRE DAMPER MANUFACTURER. COORDINATE EXACT WALL CONSTRUCTION WITH MECHANICAL PRIME CONTRACTOR PRIOR TO COMMENCING PARTITION FABRICATION.



NHC Government Center 7702-190810

**NEW HANOVER COUNTY  
GOVERNMENT CENTER**  
GOVERNMENT CENTER DRIVE  
WILMINGTON, NC 28403

LS3P PROJECT: 7702-190810

[illegible]

KEY PLAN:

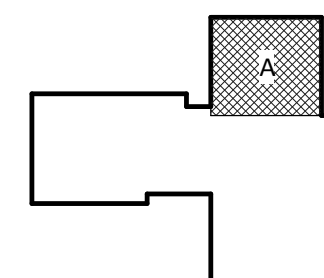

SHEET NAME:  
FLOOR PLAN- LEVEL  
4- AREA A

**ORIG SUBMISSION:** 2020.12.16

**CURRENT:** 2020.12.22

## ADDENDUM #1

**SHEET:**

**A-104A**

**GMP SET**

